

A note from Anna Maria *about her*

AMH Embroidery Collection for the Skyline S9

For me, the very best part of being a designer has everything to do with keeping endless possibilities at your finger tips. From the time I was a little girl I have loved handwork of all forms, whether sewing, embroidery, cross stitch, crochet, or knitting. I was lucky to grow up in a home where every room or every dresser drawer had something in it that was lovingly stitched by a family member. These goods- fancy or plain- served as meaningful inspiration to me as I realized my dreams in becoming an artist. Over the years I have continually drawn on that influence to develop fabric collections and design patterns for sewing, quilting and needlework.

I am so fortunate that my everyday process of design invites me to combine my love for many handcraft disciplines together into beautiful projects. Using a unique combination of elements and materials in my clothing, quilting and accessory projects helps me feel like they are one of a kind- which is especially nice when I'm making a gift. Whether I end up wearing, or sleeping under or giving away these items- they become an important part of who I am. They represent my artistic vision and my ever developing skills as a maker in a tangible way. And very often these items are a special comfort for our everyday family life in our home environment.

As much as I would jump at the chance to spend every moment of every day adding layer upon layer of handwork to all of my projects, my family and work schedule does not quite allow for that. I have a feeling that I am not the only one with that little predicament! I have also noticed over the years that when I go shopping for clothing or home goods that reflect my personal taste and style that I am always drawn to items with lovely prints, quality materials, and *embroidered details*. Usually of course, these embroideries are made on a machine.

When designing fabrics for our wonderfully creative sewing community, I have worked hard to not just create beautiful art, but also source and offer material choices that are suitable for more than just quilt making. Fabrics that feel good against your skin. Prints that give you options when you sit down to decide what's next in sewing for you. It was with this same desirability factor, and the goal of broadening your creative horizons that I designed my embroidery collection for the Janome Skyline S9. My hope is that these designs will make you feel more excited and more capable than you ever have of creating just exactly what you want in a garment (quilt, bag, pillow- you name it!) So you can stop looking at those \$300 blouses and wondering how you can get that look at home- and instead follow along with me on the simple steps of adding machine embroidery to your projects.

Your sewing is about to get really, really fun!

Xo, Anna Maria



Machine Embroidery Tips from Anna Maria Horner

Hopefully you've found a lot of inspiration in my machine embroidery collection and you're ready to begin your first project! Adding special details to your sewing does not have to be difficult or time consuming, especially when Janome makes it so simple! I want to help make your creative time more beautiful and memorable, but also more confident! So here are some of my practical tips for getting started with machine embroidery.

MATERIALS

Fabric: Janome's sewing machines can perform embroidery on almost any type of fabric that you can think of whether it's cotton, linen, silk, jersey knit or denim. The key is making sure that you have the right stabilizer.

Stabilizer: Your local Janome dealership will be able to help you pair the right embroidery stabilizer with the fabric you are using. There are a variety of types that wash away, tear away, or ones that can be left in place if desired. Some of them are fusible for temporary or permanent positioning. I like to make sure that the size of the stabilizer piece for my project is slightly larger in each direction than the hoop I will be using. This helps make sure everything gets hooped smoothly, and that the entire embroidery design is layered with both fabric and stabilizer behind it.

Thread: I have experimented with all types of threads for machine embroidery, but most often I use either polyester or rayon for my work. There are many brands out there and each of them comes in a vast array of colors. In fact many of the Janome embroidery machines have a color number system built in the machine's embroidery profiles as a reference when choosing your threads. Check with your dealer to get their experience-rich recommendations.

Bobbin: For the bobbin thread, I use one that matches the shade of my fabric. Janome's machine technology is so specialized that you don't have to worry about it showing up on top. Therefore, you also don't need to worry about changing out the bobbins each time you change out a top thread color. You'll only need to replace bobbin when it's empty- and guess what? The machine will tell you when it's empty, and remember exactly right where it stopped the embroidery so that it begins stitching again perfectly after you've replaced with a fresh bobbin.

Needles: When choosing a needle for my embroidery, I just want to be sure that it is new and sharp. I use Janome Blue Tip needles, which are size 75/11.

An Illustrated Guide to creating with Janome Embroidery

For the sake of an example, the following guide details the steps necessary to create an embroidered pillow with the design to be located in the center front of the pillow.

Preparing Fabric

1. Cut fabric for pillow front a few inches larger than the final pattern size for pillow front. Be sure to consider the fabric design/print and how you'd like it placed on the front of the pillow.
2. Mark the center of the pillow by folding in half both ways, and marking the center folded intersection with a removable fabric marker dot.

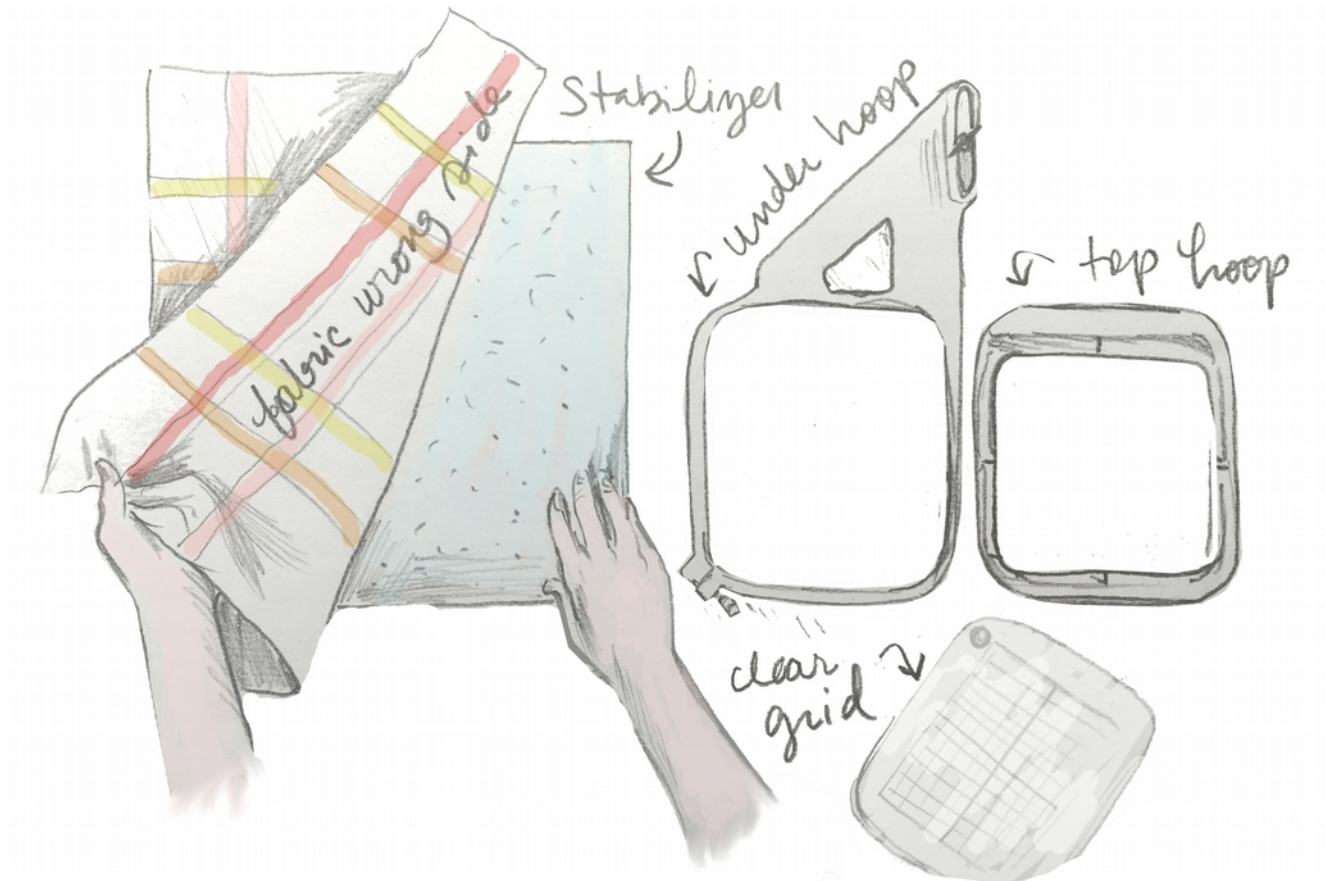

Preparing Stabilizer

1. Taking note of the recommended hoop size from the machine's on-screen guide for your chosen embroidery design, cut stabilizer to be a few inches bigger than hoop size in both directions.
2. Align center of stabilizer with center of pillow front, then layer stabilizer on the wrong side of fabric. If the stabilizer is fusible, press in place with an iron.

Thread Selection

*Janome's on-screen information will also include how many colors your chosen design contains. You can use this more as guide than an exact rule, so feel free to get creative with your thread colors! Keep in mind to achieve a well balanced design, you may consider keeping the same light/dark balance or the same warm/cool mix for your personal selections.

1. The colors shown on the screen will be in numbered order of stitching sequence. Select your desired threads. I always like to line up my threads in a row on the sewing table (sometimes with a mini post-it note reminding me of the color order on the spools in case there are little hands in the studio "helping").

2. Begin by threading the color number "1" just as you would thread the machine for regular sewing. (As previously stated you can use a bobbin that is the color of your fabric, and not worry about switching until it's empty.)

Hooping

1. Make sure the hoop you've chosen matches the on-screen suggestion with your design.

2. Position the hoop in front of you so that the screw/adjustment is at the lower left, and the turn lock for the embroidery unit is at the upper right.

3. Loosen the lower left screw and take the top/inner portion of the hoop out and set aside.

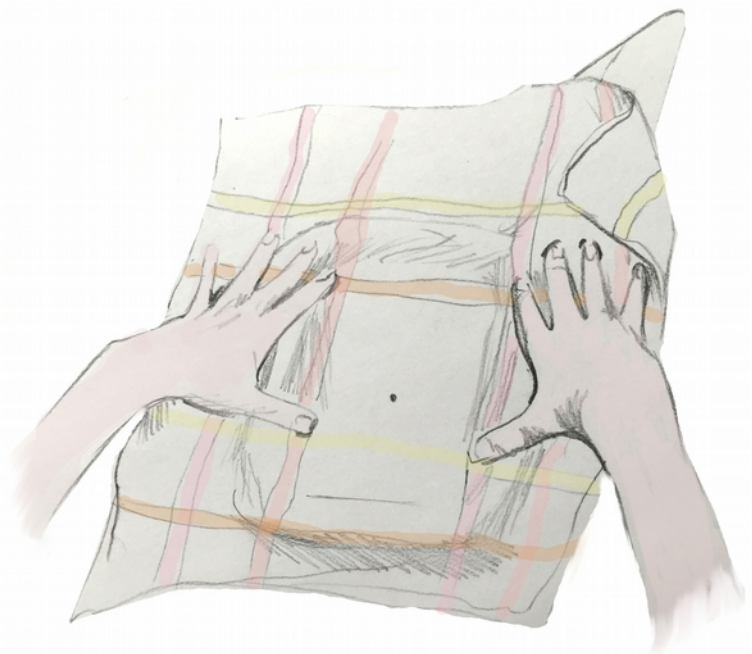
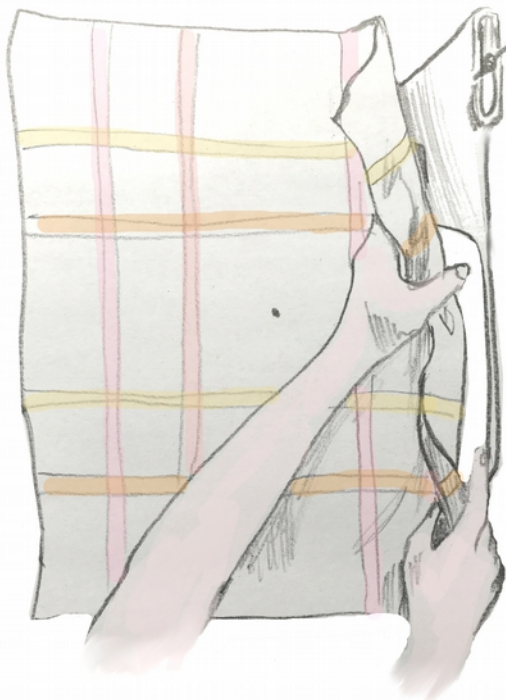

4. Lay your stabilized fabric (right side up) over the larger bottom/outer hoop, feeling the hoop underneath through the fabric to generally position the center of the fabric in the center of the hoop.

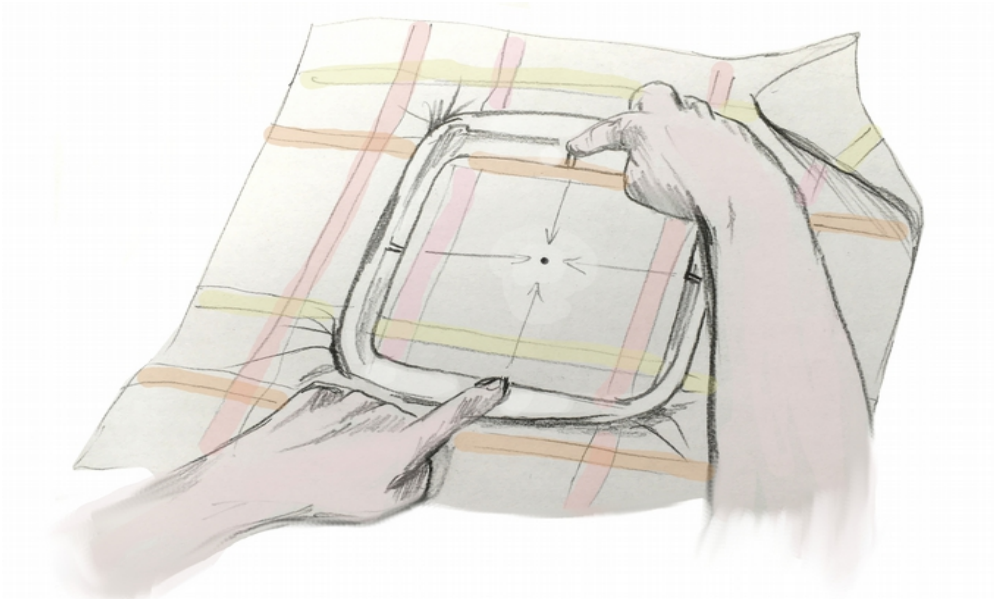

5. Lay the top/inner hoop over the fabric so that it is roughly in place over the lower/outer hoop. Do not press or snap top/inner hoop into place until you have shifted the fabric as necessary to get the center in line with center line markings on the top/inner hoop.

6. Press firmly to snap top/inner hoop in place, but do not tighten bottom left screw yet. Instead lay the clear grid that matches your hoop size over the top/inner hoop to make sure your marked fabric center matches the grid center. Additionally you may want to gently tug at the fabric/stabilizer slightly to smooth any excess fabric, or to very specifically get fabric in line along edges.

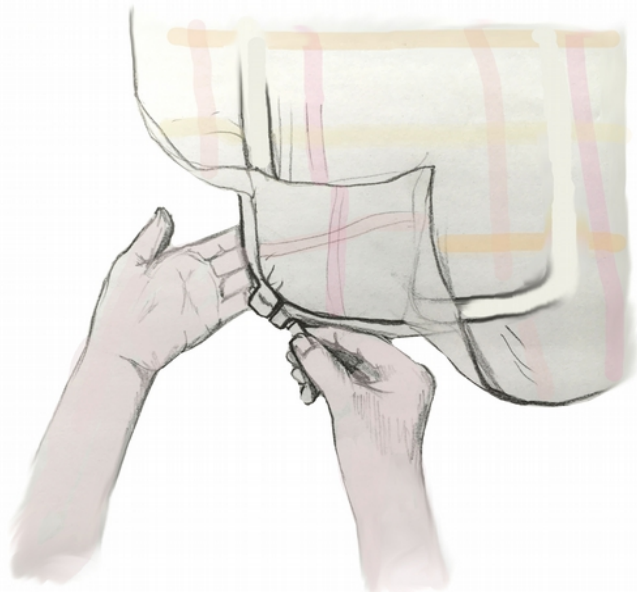
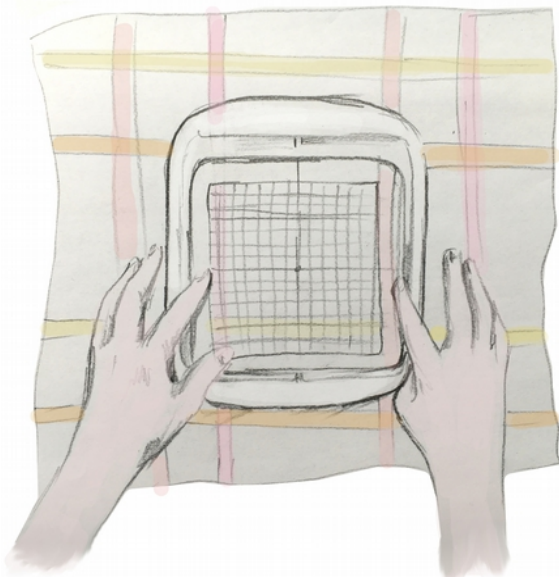

7. Once all is in place, take the clear grid off, tighten the lower left screw. Once the embroidery unit is open, you can turn lock the hoop in place, after sliding the hoop underneath the presser foot.

The Ease of Embroidery

Once the your design is selected, pay attention to everything the screen is suggesting for your use: thread colors; presser foot; and hoop size. The screen will also give plenty more information about the number of stitches in the design, how long it will take out, and even editing options. Having the embroidery unit attached even when I am doing regular sewing increases my bed space and gives the machine such a solid foundation, that I usually leave it attached. Then just a few taps on the screen allows me to move from regular sewing to embroidery in no time.

Embroidery Inspiration

Now that you know the basics, head over to Janome.com/en/inspire/anna-maria-horner/ watch my videos and download my free projects that include embroidery! See you there! And don't forget to visit your local dealer for more information about my exclusive stand alone AMH Embroidery collection as well as the collection that is built into the Skyline s9!

